

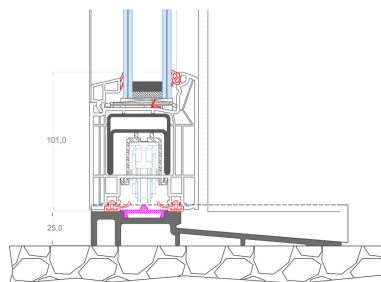

## VERTICAL SECTION

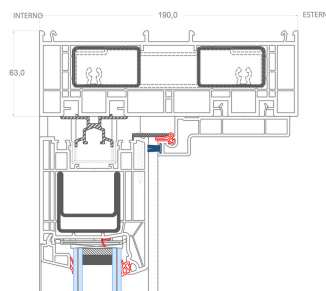

## HORIZONTAL SECTION

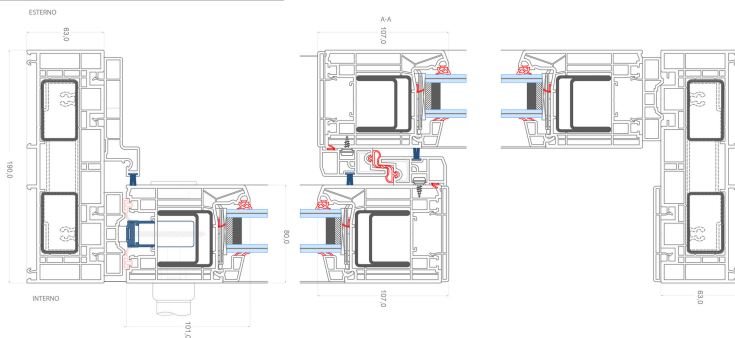

## FEATURES



### RECYCLED PVC

Windows are manufactured using high-quality recycled PVC - biodegradable, recyclable, non-toxic, fire-resistant, and eco-friendly.



### ENERGY GLASS INSULATING UNIT®

The insulating glass unit features a black warm-edge spacer and Planitherm Infinity low-emissivity and selective coating by Saint-Gobain.



### PERFECT WELDING

The welding technology completely eliminates the weld bead from the corners.



### HARDWARE

Adjustable three-dimensional hinges with silver-colored PVC hinge covers. Lever rod for the upper and lower locking of the passive sash. Upon request, concealed hardware can be integrated. Silver steel cremonese bolt with three anti-burglary locking points.



### TOULON HANDLE

The Toulon handle by Hoppe is crafted from premium materials sourced from certified manufacturers.



### SECURITY

All our product lines are equipped with certified hardware. Additionally, the integrated electronic contact alarm system is compatible with all home automation systems.



### WIDE RANGE OF COLORS

The regenerated PVC base body is available in various colors, allowing for the combination of 42 decorative films from the REHAU color chart, achieving the desired aesthetic for any project.



### WARRANTIES

Thanks to the performance and reliability of its windows, PBFinestre has earned prestigious certifications from International Institutes. All products are covered under legal warranty.

## TECHNICAL DATA

### Air Permeability Resistance Class\*

(according to the UNI EN 1026 – 2001 test standard and the UNI EN 12207 – 2000 classification standard)

### Class 4

Indicates how much the fixture is permeable to air passing through it at a pressure of 600 Pa, which corresponds to a wind speed of 115 km/h.

### Water Tightness Resistance Class\*

(according to the UNI EN 1027 – 2001 test standard and the UNI EN 12208 – 2000 classification standard)

### 9A

Indicates the fixture's ability not to be penetrated by water under a pressure of 600 Pascal.

### Wind Load Resistance Class\*

(according to the UNI EN 12211 – 2001 test standard and the UNI EN 12210 – 2000 classification standard)

### class B3

Indicates the fixture's ability to resist the wind pressure at a specific speed.

### Acoustic Reduction Certification\*\*

### up to 40 dB

(with 44.1 Stadiip Silence glass Planitherm Infinity + 16 Argon gas + 33.1 Stadiip Protect - 51 mm thick sections)

### Thermal Performance Certifications\*\*

Achievable Uw values: **1.3 W/m²K** in the version with a thickness of 51 mm

Solar Factor **G=0,35**

\*As per certifications in our possession issued by the ROSENHEIM Institute  
\*\*As per certification in our possession issued by the GIORDANO Institute



Products conforming to the European standard EN 14351-1. All our windows are CE marked, according to the law.